



art metal

05 DAWID LED

Construction:

The unit consists of a body (1) which supports a ring (3) holding a PC shade (2). The ring (3) separates electrical from optical part. A radiator (4) with LED module (5) and lens (6) is attached to the ring (3). LED module (5) is powered with power supply (7). The luminary is sealed with a gasket (8).

Mounting instructions:

- *)- Mount the radiator (4) with LED module (5) and lens (6) to the ring (3).
- Make electric connections according to markings.
- Mount the ring (3) with screws to the body (1)
- Mount the shade (2) in the ring (3), tighten the screws.
- The luminary is mounted to the lantern with an internal M20 thread (9)

If any lantern element is supplied factory-mounted, the mounting stages marked with *) should be omitted (as this has already been done by the manufacturer).

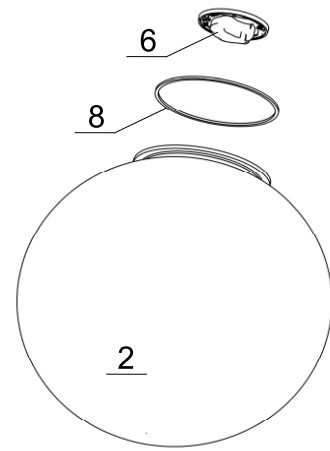
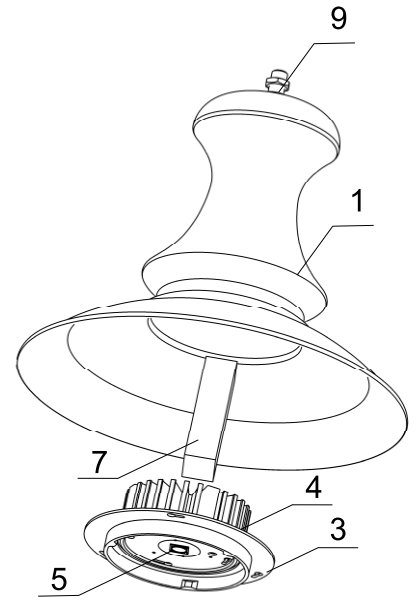

TECHNICAL DATA:

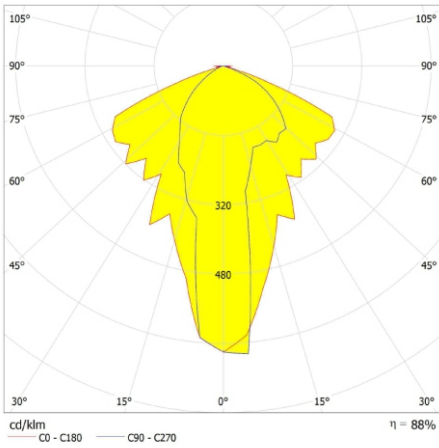

Photometry (polar plot)

Power: ~230/50Hz

Protection class: I

IP66 - electrical part

IP66 - optical part

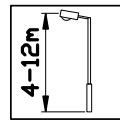

ELECTRICAL DIAGRAMS:

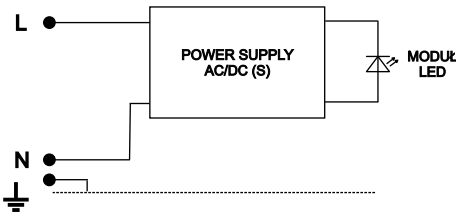

1. Module LED - basic power supply (S)

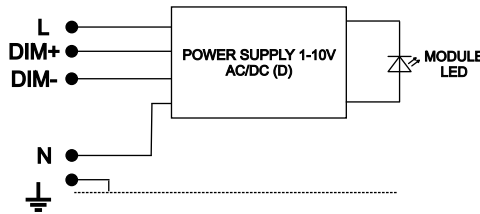

2. Module LED - dimmable power supply (D)

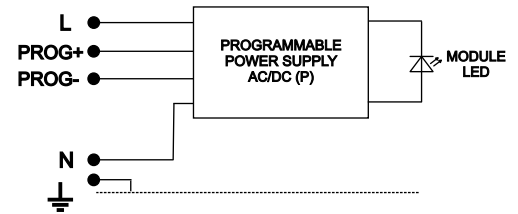

3. Module LED - programmable power supply (P)

Type	Light-prod. element	Luminous flux (lm)		Weight [kg]	Pn [W]	Luminary dimensions		
		3000K (830)	4000K (840)					
05L-22W	CXB2540	2990	3170	9,5	22			
05L-33W	CMA2550	4286	4609	9,5	33			
05L-38W	CMA2550	4842	5207	9,5	38			
05L-50W	CMA2550	6131	6593	9,5	50			
						Wind area A = 0,19m ²	L/D 750/505	

WARNING !! The weight of the unit may slightly differ for individual production batches.

