

**UKŁAD RAMION**  
ARMS CONFIGURATION

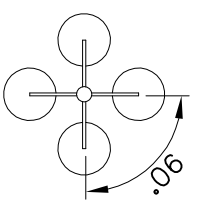

**MALOWANIE:**

**PAINTING**

POWŁOKA ANTYKOROZYJNA (ANTICORROSIVE PAINT)  
KOLOR (COLOUR) RAL 7021

**FUNDAMENT:**

FOUNDATION F100A  
FUNDAMENT NIE WCHODZI W SKŁAD ZESTAWU  
FOUNDATION IS NOT INCLUDED INTO THE SET.

| nazwa/name  | wartość value |
|---|---------------|
| strefa obciążenia wiatrem wind zone                         | I             |
| wsp. dynamiczny dynamic rate                                | 1,2           |
| kategoria terenu terrain category                           | II            |
| klasa obciążenia load class                                 | A             |
| częściowy wsp. dla obc. wiatrem partial rate for wind load  | 1,4           |
| częściowy wsp. dla obc. stałego partial rate for fixed load | 1,2           |
| obciążeniowa prędkość wiatru wind speed                     | 22 [m/s]      |

ACCORDING TO: PN-EN 40-3-1, PN-EN 40-3-3

|  |  |  |                            |             |           |  |           |  |  |          |               |                  |                            |  |      |           |   |                  |  |            |            |                         |                  |  |                 |  |         |                |  |  |  |           |          |  |
|--|--|--|----------------------------|-------------|-----------|--|-----------|--|--|----------|---------------|------------------|----------------------------|--|------|-----------|---|------------------|--|------------|------------|-------------------------|------------------|--|-----------------|--|---------|----------------|--|--|--|-----------|----------|--|
| 8  | Przewód/Cable YDY 3x1,5mm <sup>2</sup> | -  | -                          |             |           |  |           |  |  |          |               |                  |                            |  |      |           |   |                  |  |            |            |                         |                  |  |                 |  |         |                |  |  |  |           |          |  |
| 7  | Tabliczka przyłączeniowa / Fuse box    | -  | 1                          |             |           |  |           |  |  |          |               |                  |                            |  |      |           |   |                  |  |            |            |                         |                  |  |                 |  |         |                |  |  |  |           |          |  |
| 6  | Oprawa/Luminary 04 ARIES               | poliwęglan/aluminium polycarbonate/aluminium | 4                          |             |           |  |           |  |  |          |               |                  |                            |  |      |           |   |                  |  |            |            |                         |                  |  |                 |  |         |                |  |  |  |           |          |  |
| 5  | Ramię/Arm R14                          | aluminium                                    | 4                          |             |           |  |           |  |  |          |               |                  |                            |  |      |           |   |                  |  |            |            |                         |                  |  |                 |  |         |                |  |  |  |           |          |  |
| 4  | Ozdoby/ Decorations                    | odlew aluminiowy (AK9) aluminium cast (AK9)  | 1                          |             |           |  |           |  |  |          |               |                  |                            |  |      |           |   |                  |  |            |            |                         |                  |  |                 |  |         |                |  |  |  |           |          |  |
| 3  | Rura stalowo/Steel pipe ø76            | stal/steel (S235)                            | 1                          |             |           |  |           |  |  |          |               |                  |                            |  |      |           |   |                  |  |            |            |                         |                  |  |                 |  |         |                |  |  |  |           |          |  |
| 2  | Rura stalowo/Steel pipe ø159           | stal/steel (S235)                            | 1                          |             |           |  |           |  |  |          |               |                  |                            |  |      |           |   |                  |  |            |            |                         |                  |  |                 |  |         |                |  |  |  |           |          |  |
| 1  | Maskownica/Masking frame               | żeliwo/iron cast (GJL200)                    | 1                          |             |           |  |           |  |  |          |               |                  |                            |  |      |           |   |                  |  |            |            |                         |                  |  |                 |  |         |                |  |  |  |           |          |  |
| Nr   | Nazwa elementu/Element                 | Materiał/material                            | ilość quantity             | uwagi notes |           |  |           |  |  |          |               |                  |                            |  |      |           |   |                  |  |            |            |                         |                  |  |                 |  |         |                |  |  |  |           |          |  |
| <table border="0"> <tr> <td colspan="2">Opracował</td> <td>Producent</td> <td colspan="2"></td> </tr> <tr> <td>Drawn by</td> <td>Nazwisko/Name</td> <td>ART-METAL Sp. J.</td> <td colspan="2">FIRMA PRODUKCYJNO-HANDLOWA</td> </tr> <tr> <td>Ł.B.</td> <td>Data/Date</td> <td>ul. Jabłoniowa 124, 83-331 Kapino Kartuskie</td> <td colspan="2">ART-METAL Sp. J.</td> </tr> <tr> <td>15.01.2019</td> <td>15.01.2019</td> <td>tel. (+48) 58 681 80 78</td> <td colspan="2">www.art-metal.pl</td> </tr> <tr> <td colspan="2">produkt/product</td> <td>hc=5000</td> <td colspan="2">ST4/4KR14/4K04</td> </tr> <tr> <td colspan="2"></td> <td>ST4/129/4</td> <td colspan="2">STANDARD</td> </tr> </table> |  |  |                            |             | Opracował |  | Producent |  |  | Drawn by | Nazwisko/Name | ART-METAL Sp. J. | FIRMA PRODUKCYJNO-HANDLOWA |  | Ł.B. | Data/Date | ul. Jabłoniowa 124, 83-331 Kapino Kartuskie | ART-METAL Sp. J. |  | 15.01.2019 | 15.01.2019 | tel. (+48) 58 681 80 78 | www.art-metal.pl |  | produkt/product |  | hc=5000 | ST4/4KR14/4K04 |  |  |  | ST4/129/4 | STANDARD |  |
| Opracował  |  | Producent                                    |                            |             |           |  |           |  |  |          |               |                  |                            |  |      |           |   |                  |  |            |            |                         |                  |  |                 |  |         |                |  |  |  |           |          |  |
| Drawn by   | Nazwisko/Name                          | ART-METAL Sp. J.                             | FIRMA PRODUKCYJNO-HANDLOWA |             |           |  |           |  |  |          |               |                  |                            |  |      |           |   |                  |  |            |            |                         |                  |  |                 |  |         |                |  |  |  |           |          |  |
| Ł.B.   | Data/Date                              | ul. Jabłoniowa 124, 83-331 Kapino Kartuskie  | ART-METAL Sp. J.           |             |           |  |           |  |  |          |               |                  |                            |  |      |           |   |                  |  |            |            |                         |                  |  |                 |  |         |                |  |  |  |           |          |  |
| 15.01.2019   | 15.01.2019                             | tel. (+48) 58 681 80 78                      | www.art-metal.pl           |             |           |  |           |  |  |          |               |                  |                            |  |      |           |   |                  |  |            |            |                         |                  |  |                 |  |         |                |  |  |  |           |          |  |
| produkt/product  |  | hc=5000                                      | ST4/4KR14/4K04             |             |           |  |           |  |  |          |               |                  |                            |  |      |           |   |                  |  |            |            |                         |                  |  |                 |  |         |                |  |  |  |           |          |  |
|  |  | ST4/129/4                                    | STANDARD                   |             |           |  |           |  |  |          |               |                  |                            |  |      |           |   |                  |  |            |            |                         |                  |  |                 |  |         |                |  |  |  |           |          |  |
| skąd/scarce  | ortkuszt/sheet                         | tolerancja/tolerance: +/- 20mm               |                            |             |           |  |           |  |  |          |               |                  |                            |  |      |           |   |                  |  |            |            |                         |                  |  |                 |  |         |                |  |  |  |           |          |  |
| 1:30   | A4                                     |  |                            |             |           |  |           |  |  |          |               |                  |                            |  |      |           |   |                  |  |            |            |                         |                  |  |                 |  |         |                |  |  |  |           |          |  |